

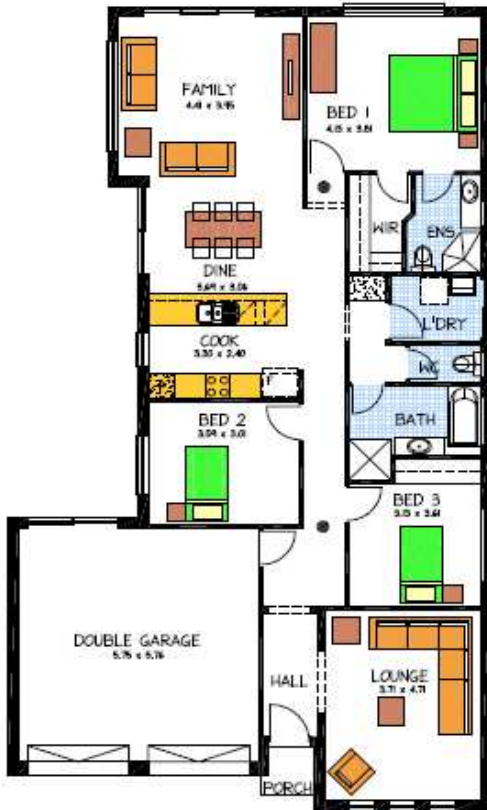

**Rossdale
Homes**

Because trust is a must

House & Land Package



Allotment 15 Onkaparinga Rise

KYTON

\$377,750



This package includes:

Rossdale Homes 'Kyton' design built to Select specification

- 3 Bedroom
- 2 Bathrooms
- 2.4m ceilings
- 2500 litre rainwater tank with rain bank
- 2 Separate living areas
- Ceiling, external and internal wall insulations
- Double garage
- Automatic roller doors and internal access

- All services are included along with NBN ready.
- All cabinetry is included with overhead cupboards to kitchen, built in robe to bedroom 3 and all laundry and linen cupboards
- Quality Westinghouse appliances including retracta range-hood & instantaneous hot water system
- Healthy footings allowance with all excess soil removed from site
- Front elevation is rendered and painted allowing 2 colors along with Rusitic Bookleaf Stack Stone to brick pier

STAGE ONE SPECIALS:

FREE Retaining | FREE Rear Fence | FREE Front Landscaping

Disclaimer: All care has been taken in the preparation of this material. No responsibility is taken for any errors or omissions. Details are subject to change without notification. Images for illustration purposes only. E&EO.

**PACKAGE FROM: \$377,750
HOME: \$194,250 LAND: \$183,500**

FOR THIS OFFER CALL

GUY 0411 176 020

Because trust is a must

www.rossdalehomes.com.au