

House & Land Package

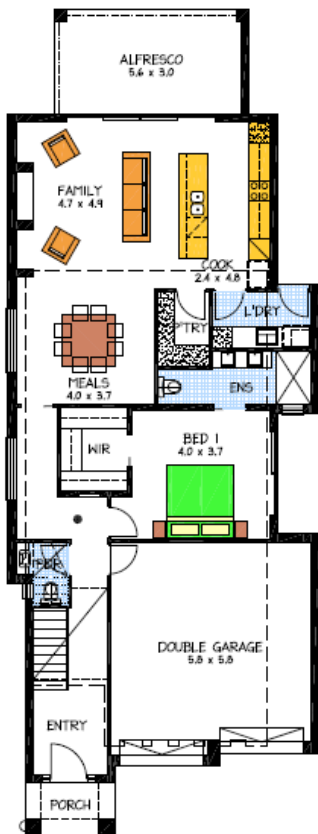
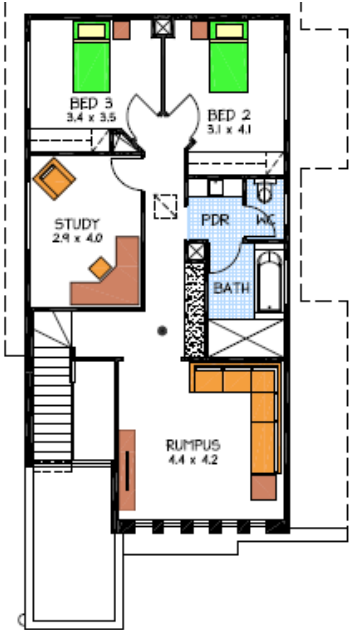

THE HOLDFAST

May Terrace Brooklyn Park

This package includes:

- High ceilings
- "As Displayed" Kitchen upgrades
- "As Displayed" Façade detail
- Site costs allowance
- Optional polished concrete floors
- Quality carpet upstairs
- Tiled Alfresco and Porch
- Land size 533m² with 10.65m frontage opposite parklands
- Optional Bedroom 1 upstairs layout available

PACKAGE FROM: **\$895,500**

HOME: **\$395,500** LAND: **\$500,000**

Disclaimer: All care has been taken in the preparation of this material. No responsibility is taken for any errors or omissions. Details are subject to change without notification. Images for illustration purposes only. E&EO.

FOR THIS OFFER CALL

GEOFF GREENOW 0439 262 888

Because trust is a must

www.rosdalehomes.com.au