

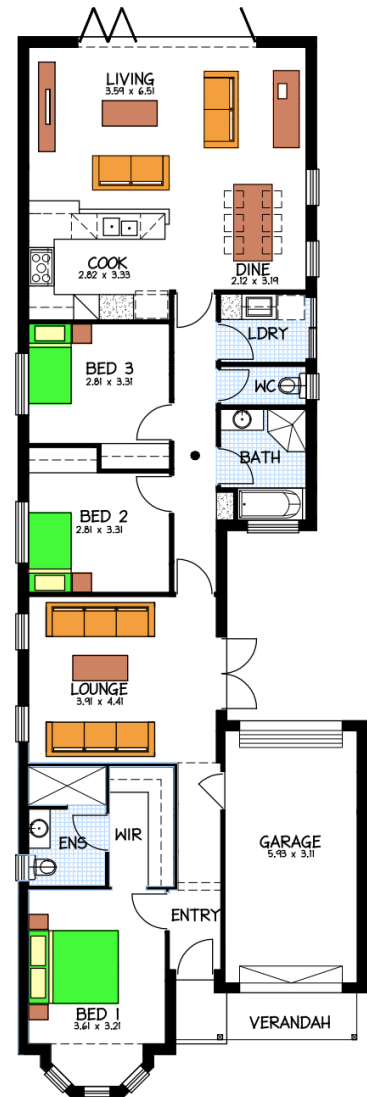

## MURRELL ROAD PARA HILLS SA 5096



### This package includes:

- Total site area is 319sqm with 9.7m frontage
- Davenport Terrace Design to Rossdale's Sovereign Specification (total house area:167.5sqm)
- Smart design Including bedrooms and 4 living areas and home theatre
- 2.7m ceiling height to both floors
- Front loader garage and internal access
- ENS and WIR to Bed 1
- Instantaneous Hot Water System
- NBN ready
- Upgraded 900mm wide kitchen wares
- Dishwasher
- Standard footings allowance
- Ducted reverse cycle air conditioning system
- Fully floor covering
- Letter box and clothing lines ready
- Fixed Price Quotation Including engineers footing report before signing contract
- 25 Year Structural Warranty
- Easy finance
- Show home is available for inspection
- Other designs available

### HOUSE & LAND PACKAGE

**FROM: \$364,371**

**Home: \$215,371 Land: \$149,000**

Images for illustration purposes only.

FOR THIS OFFER CALL

**CHEN XIE**  
**0451 286 777**

*Because trust is a must*  
[www.rossdalehomes.com.au](http://www.rossdalehomes.com.au)