

# House & Land Package



## THE ENVOY

Lot 741 Filly Street, St Clair

This package includes:

- Large four bedroom home
- Separate home theatre
- Ensuite and walk in robe to Bed 1
- Floor coverings throughout
- Stormwater connection
- NBN Connection
- Generous footings allowance
- Paving to driveway and perimeter path
- 420sq meters of land

PACKAGE FROM: \$652,700

HOME: \$192,700 LAND: \$460,000

Disclaimer: All care has been taken in the preparation of this material. No responsibility is taken for any errors or omissions. Details are subject to change without notification. Images for illustration purposes only. E&EO.

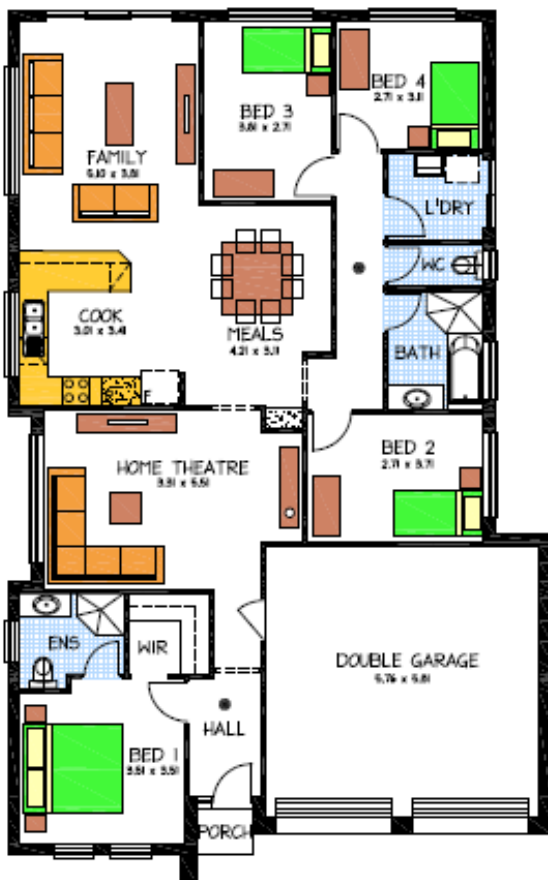

FOR THIS OFFER CALL

TIFFANY: 0422 072 598

*Because trust is a must*

[www.rossdalehomes.com.au](http://www.rossdalehomes.com.au)